

M-331-96

"NEW" STYLE CAGE ASSEMBLY **(AFTER JAN. 1, 1996) NOTE NEW TORQUE VALUES 8/97**

A newly designed valve cage assembly will go into production in mid January 1996. The new cage assembly will incorporate a new valve cage assembly (Item 26A) and springs (Item 26G). The other parts will remain the same.

The "New" style cage assembly will provide slightly increased compressor performance and longer valve and spring life, thus requiring less maintenance. This "New" style cage assembly will supersede the "Current" style valve cage assembly which will no longer be available.

Updating the new cage assembly is recommended when valve maintenance is required.

NOTE: A new valve cage bolt (Item 26E) torque has been implemented. The new torque value is 45-48 FT/LB.

CAUTION: Do not use the "Current" style design springs that do not have the hour-glass shape in the "New" style valve cage (item 26A). Compressor failure will result.

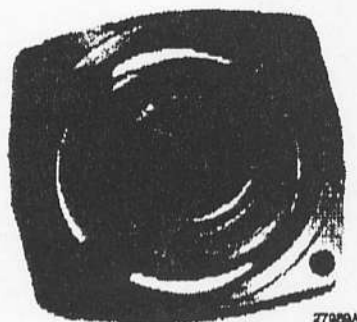

**VALVE CAGE ASSEMBLY
(BOTTOM VIEW)**



**VALVE CAGE ASSEMBLY
(TOP VIEW, NOTE THE "X" DESIGN)**

NOTE:
TORQUE TO
15, THEN 30
FT/LB. (WAS
20 FT/LBS.)
(REVISED 8/97)

ITEM NO.	DESCRIPTION	PART NO.
26	Cage, Discharge Valve Assembly: Includes Items A, B, C, D, E, F, G	664-48785
26A	Cage, Discharge Valve	064-48787
26B	Plate, Inner Valve	084-48032
26C	Valve, Discharge	064-43012
26E	Screw, Cap Button Head	021-17649
26F	Nut, Hex Self Locking	021-09932
26G	Spring, Helical	029-21788

CLOSE-UP OF SPRING
SITTING ON END

NOTE: HOUR-GLASS
SHAPE

CLOSE-UP OF
SPRING LAYING
HORIZONTAL

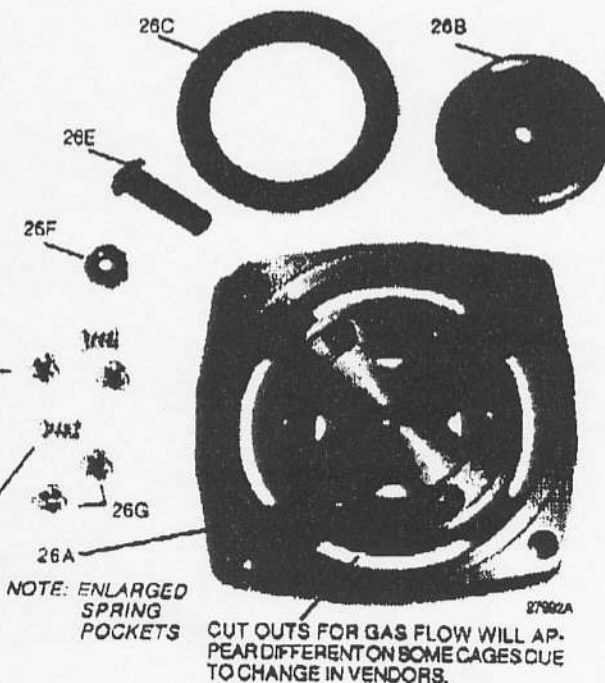

NOTE: ENLARGED
SPRING
POCKETS

CUT OUTS FOR GAS FLOW WILL AP-
PEAR DIFFERENT ON SOME CAGES DUE
TO CHANGE IN VENDORS.

DISCHARGE VALVE CAGE ASSEMBLY (NEW DESIGN)